

Weyn-Lauwers N.V.

Industriepark-Noord 12
B - 9100 SINT-NIKLAAS

Tel. : 00 32 (0)3 776.34.13
Fax : 00 32 (0)3 778.09.52
weynlauwers@weynlauwers.be
www.weynlauwers.be

POSITIONER
Ex dmb IIC T5/T6
4-20 mA
manual

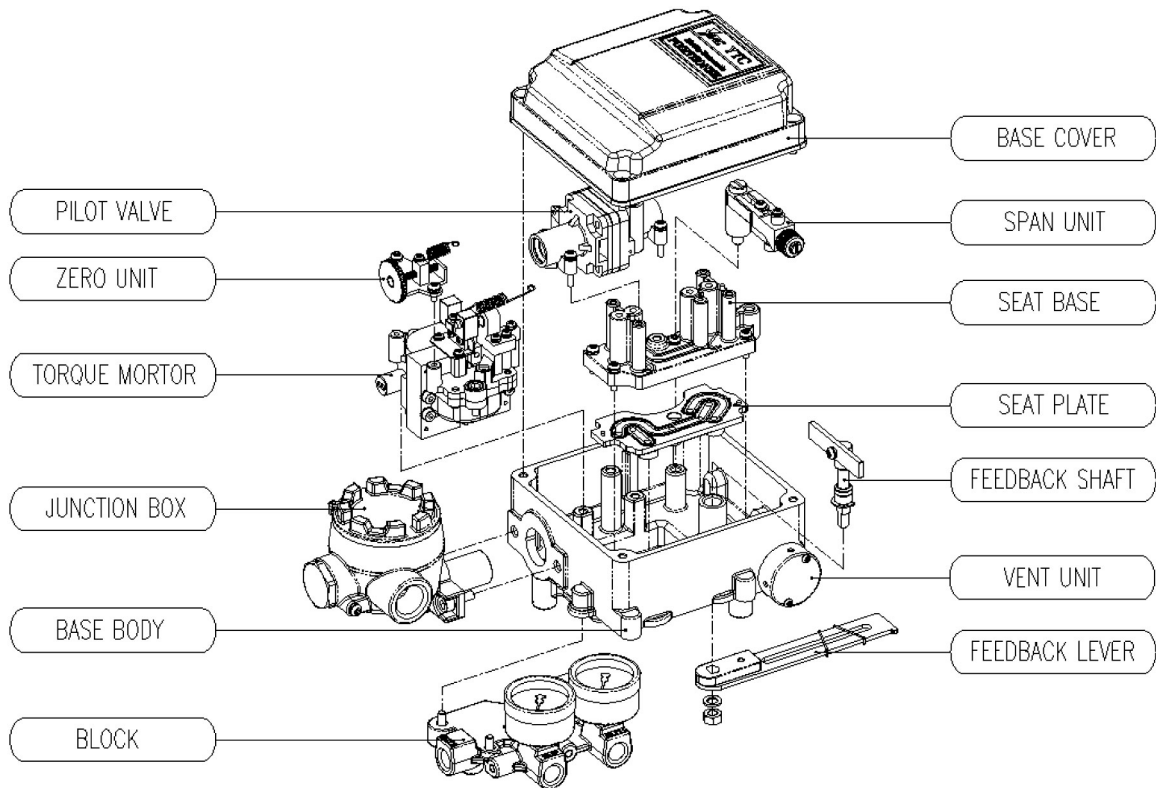

Adjustment – Zero Point

1. Set supply signal at 4mA or 20mA – according to RA or DA – and rotate the adjuster up or downward to adjust actuator's initial point. As zero point is being set, the specification of the valve system must be considered. Please refer to diagram on the right to increase or decrease the zero point.

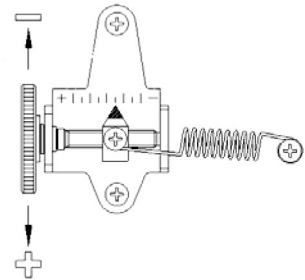

Adjustment – Span

1. After setting zero, supply signal at 20mA or 4mA – according to RA or DA – and check the actuator stroke. If the stroke is too low, the span should be increased. If the stroke is too high, the span should be decreased.
2. Changing span point will affect zero point setting. Zero point should be set again after span has been adjusted. This step is required until both zero and span are properly set.
3. After proper setting, tighten lock screw.

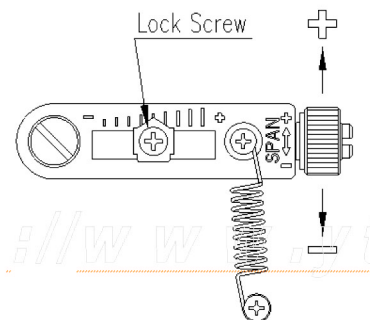

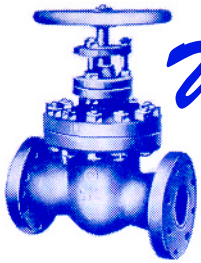

Weyn-Lauwers N.V.

Industriepark-Noord 12
B - 9100 SINT-NIKLAAS

Tel. : 00 32 (0)3 776.34.13
Fax : 00 32 (0)3 778.09.52
weynlauwers@weynlauwers.be
www.weynlauwers.be

POSITIONER Ex dmb IIC T5/T6 4-20 mA manual

Adjustment – A/M Switch (Auto/Manual)

1. A/M switch is used when the valve needs to be operated manually.
2. If switch is set as “A”, the positioner will respond to input signal. If switch is set as “M”, the positioner will act as bypass and supply pressure to the positioner will directly go to the actuator.
3. **Please make sure to set back to “A” after manual operation. Also, please DO NOT TOUCH SEAT ADJUSTER BOLT ON THE PILOT RELAY.**

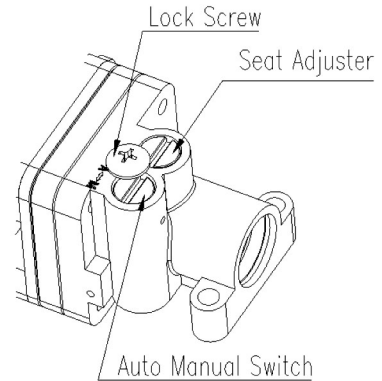

Maintenance

Maintenance on pilot relay valve is recommended to perform at least once a year of with or without operation. When disassembling the pilot relay valve, please be careful not to loose any o-rings or stabilizer spring. Please refer to below instruction and diagram.

1. Please remove pilot relay lock bolts.
2. Unlock Auto/Manual (A/M) Switch from the pilot relay. **PLEASE MAKE SURE TO REMOVE A/M SWITCH.**
3. Remove any particles or dust by blowing air.

