



Weyn-Lauwers N.V.

Industriepark-Noord 12
B - 9100 SINT-NIKLAAS

Tel. : 00 32 (0)3 776.34.13
Fax : 00 32 (0)3 778.09.52
weynlauwers@weynlauwers.be
www.weynlauwers.be

EXPANSION JOINT SS BELLOW FIG 974

DESIGN FEATURES

- expansion joint dn25 - dn200 PN16
- Stainless steel bellow (AISI 304)
- temp : -40°C +300°C
- specifications :
 - absorbs axial movement with internal liner
 - steel flanges according PN16
 - limit rods for DN50 to DN200

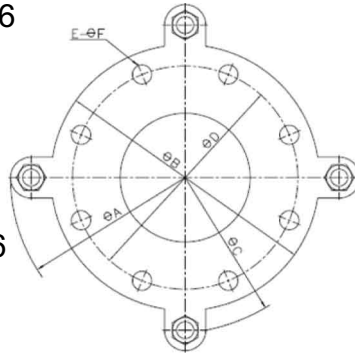

USE

- for common fluids
- axial movement only
- respect the flow direction indicated by arrow

MATERIALS

item	Part name	Material
1	flange	carbon steel painted
2	pipe	carbon steel painted
3	bellow	SS 304 (1.4301)
4	internal liner	SS 304 (1.4301)
5	rod	carbon steel painted
6	washer	rubber
7	nut	carbon steel painted

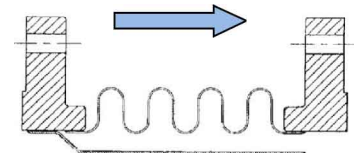
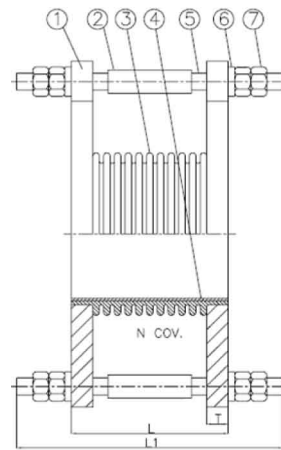

DN	Presión de Trabajo / Working Pressure (bar)	Temperatura de trabajo / Working Temperature (°C)	Compensación Axial en diferentes ciclos de trabajo (mm) / Axial compensation in different cycle (mm)			Indice de Elasticidad Axial / Axial Spring Rate (Kgf/mm)	Area Efectiva / Effective Area (cm ²)
			1000 Ciclos / Cycle	>>5000 Ciclos / Cycle	>> 10000 Ciclos / Cycle		
25	16	300	± 11	± 6	± 5	40	16,3
32			± 11	± 6	± 5	40	16,3
40			± 11	± 6	± 5	40	16,3
50			± 15	± 9	± 7	28	27,3
65			± 17	± 9	± 7	33	47,3
80			± 17	± 9	± 7	34	58
100			± 16	± 9	± 6	45	98,5
125			± 14	± 8	± 6	63	160,6
150			± 18	± 10	± 8	76	228,3
200			± 26	± 15	± 12	56	366,4

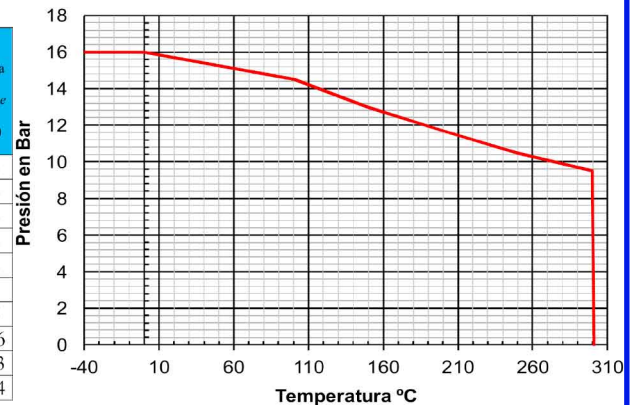

DN	25	32	40	50	65	80	100	125	150	200
L	170	170	170	170	170	170	170	170	220	220
L1				245	245	245	245	265	315	315
T	16	16	16	16	18	18	20	20	23	23
rods				3xM12	3xM12	3xM12	4xM16	4xM16	4xM16	4xM16
E-dia.F	4-14	4-18	4-18	4-18	4-18	8-18	8-18	8-18	8-23	12-23
Nr.Conv.	11	11	11	11	11	12	12	11	12	12
dia. A				235	255	270	305	360	390	430
dia. B	115	140	150	165	185	200	220	250	285	340
dia. C				195	215	230	250	287	322	377
dia. D	85	100	110	125	145	160	180	210	240	295
Kv (m ³ /h)	70	70	70	170	385	512	1418	2210	3557	6012
kg	2,65	3,70	4,28	7,60	9,50	10,5	13,5	19,7	26,0	30,8
ref.	207757	207758	207759	207760	207761	207762	207763	207764	207765	207766